

CABLE DESIGN
SUSPENSION
GRIPLOCK
LOCK GRIPPERS
PRECISION
QUALITY ENGINEERING
STRENGTH
ADJUSTABLE
SIMPLICITY
INNOVATION
GRIPLOCK SINCE 1992 RELIABILITY
ELEGANCE
GRIP



Conductive Cable Suspension System for LED. Patent Pending

Griplock's® new fully adjustable Conductive Cable System is stronger than copper – more conductive than steel. Each 3/32" cable is the equivalent of a 22 AWG conductor, yet has a 100lb safe working load when used with Griplock® Grippers. The high tensile strength of the cable allows it to both support and power any low-voltage Class II fixture. Cables may be used for pendant luminaires, horizontally supported halogen spotlights, cable supported shelving and other LED systems.



The "Spyder" by Beghelli USA

GRIPLOCK® SYSTEMS: READY WHEN YOU ARE!

Conductive Cable Suspension System.....	page 2
About Us.....	page 4-5
Grippers for 1/32" - 3/64" Cable.....	page 6
Grippers for 3/64" - 1/16" Cable.....	page 7-9
Grippers for 1/16" - 5/64" Cable.....	page 10
Grippers for 1/16" - 2.5mm Cable.....	page 11
Grippers for 3/32" - 1/8" Cable.....	page 12
Hooks for 1/32" - 1/8" Cable.....	page 13
Rings and Forks for 1/32" - 1/8" Cable.....	page 14
Powerfeeds and Sputniks.....	page 15
Cable Couplers and Connectors.....	page 16
Cable Couplers.....	page 17
Griplock® Industrial / CableFast®.....	page 18-21
Generic Suspension Kits.....	page 22-23
Cable Sleeves and Terminals.....	page 24-25
Accessories.....	page 26-27
Installation Guidelines.....	page 28
Weightload Guidelines.....	page 29
Cable, Thread, and Knock Out Sizes.....	page 30
Seismic and Lighting Track.....	page 31

ABOUT US

Griplock® Systems designs, engineers, manufactures and distributes adjustable and fixed cable suspension systems for use in the lighting, retail display, art, suspended ceiling, trade show, theatrical rigging and defense industries. Since 1992 Griplock® has provided manufacturers and contractors with the highest quality, most reliable cable suspension products available anywhere.

THE GRIPLOCK® GRIPPER

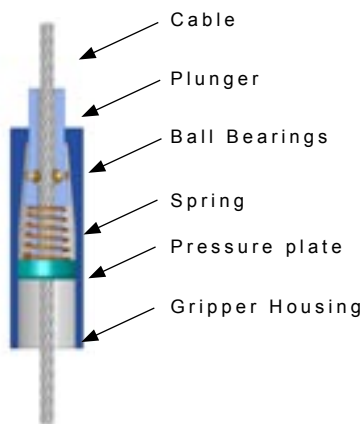

The Griplock® Gripper is a unique, self-locking and completely adjustable suspension device for use with aircraft cable. It offers instant and precise height adjustability, while radically reducing installation time and eliminating human error. It is by far the strongest and simplest way to suspend not only lighting but all types of suspended fixtures, making it the system preferred by manufacturers, distributors and installers worldwide.

Machined to three decimal point specifications, the moving parts of its internal mechanism assure 100% reliability of performance. Continuous product evolution and refinement make ours the most versatile cable suspension system of its kind in the world.

WHERE IT STOPS IT LOCKS®

Griplock® Grippers. Sophisticated in design, simple to use:

- Insert the cable through the plunger into the gripper mechanism. Slide the gripper to the desired position.
- To re-adjust, depress the plunger with your fingertip and move the gripper to a new position. Release the plunger to lock.
- The 3- or 6-ball gripping mechanism is spring-loaded and allows the gripper to move freely UP the cable. While there is any weight at all on the cable, the gripper cannot move DOWN the cable unless the plunger is depressed.
- An optional safety nut or safety cap can be added to completely lock the mechanism in both directions.



GRIPLOCK®

Griplock®, our primary Lighting Product line, includes grippers, couplers, cables, ceiling canopies, power cords and accessories. In addition to our own product line, Griplock® is the exclusive distributor in North, Central America and the Caribbean for the full range of cable suspension products manufactured by Reutlinger GmbH of Frankfurt, Germany.

GRIPLOCK® INDUSTRIAL / CABLEFAST

Griplock® also provides cable suspension products for the Industrial Lighting market. See pages 18-21. These “ZF” grippers are an excellent choice for applications where cost is a primary factor. **Griplock® Systems recommends a lower Safe Working Load (SWL) for ZF grippers than its other gripping products.** See pages 28 and 29.

SUSPENSION KITS

For Griplock's® range of off-the-shelf ceiling kits see pages 22 and 23, and the example drawing opposite. These kits are ready to go – just add the gripper of your choice.

CUSTOM DESIGNS, ENGINEERING AND CUSTOMER SERVICE.

Any combination of Griplock® products can be assembled, packaged and labeled according to customer specifications. Customers may supply their own parts and instruction material for inclusion in their kits. Pricing is significantly lower than the cost of individual components purchased “a la carte.” SolidWorks drawings of customer kits are available at no charge. Griplock® engineering and sales staff are ready to help customers in their selection of cables, couplers and grippers. If you still can't find the part you need we'll design and build it for you.*

Fig 1.2

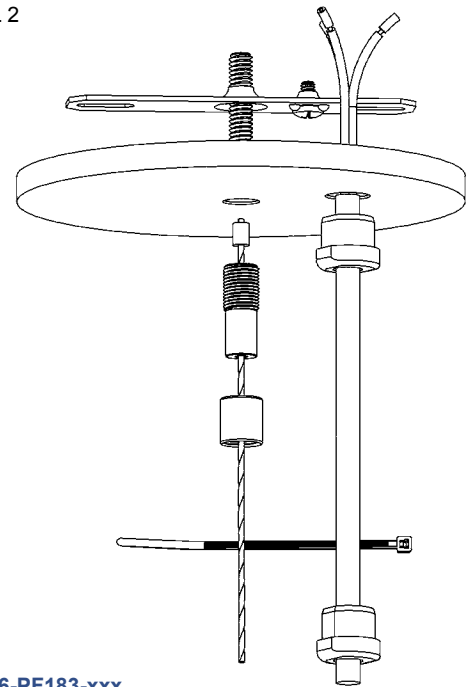

Kit:
G-AG16-PF183-xxx

QUALITY AND SAFETY

As all manufacturers and installers know, suspending pendant light fixtures safely is their first and most critical responsibility. Improper installation and the wrong choice of components can have devastating consequences. Griplock's® reputation is built on safety, quality control, customer service and 20 years of experience. Our customers know that we stand squarely behind our products.

Griplock's® quality system is modeled after ISO 9001. Prior to assembly, all individual Griplock® Gripper components are tested randomly to meet Griplock's® high quality control standards. Before shipping, every assembled unit is visually inspected. Every production run of existing parts, new designs and design revisions undergoes its own rigorous testing regime.

*Minimums apply

TYPE-10 FOR 1/32" AND 1MM CABLE



10-M6-AT
M6 x 1 thread.
2 x M6 nuts incl.



10-M6-KFT
M6 x 1 thread
M6 nut incl.



10Z-M4i
M4 x 0.7 int. thread

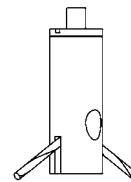

10Z-M4-SL1.1
Cross-Cable Gripper
M4 Set screw incl.



10-NT-RR
Reverse Release Gripper
3 lbs. Max. Static Load

TYPE-12 FOR 1/32" TO 3/64" CABLE

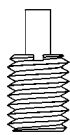

12-M8-AT*
M8 x 1.25 thread.
2 x M8 nuts incl.

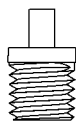

12-M8-KFT*
M8 x 1 thread
M8 nut incl.

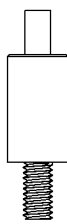

12-M4e
Cable exits thru' thread
M4 nut incl.



12-K12
Spherical Gripper
Cable exits at bottom



12-NT-RR
Reverse Release
Gripper

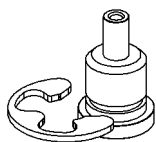

12-NT-KFB
E-Clamp incl.

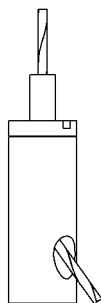

12Z-M4i
M4 int. thread
M4 bolt incl.



12Z-M4OR-SL1.6
Cross-Cable Gripper

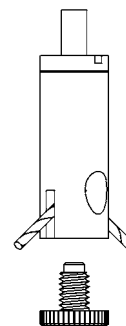

12Z-M4R2-SL1.6
Cross-Cable Gripper

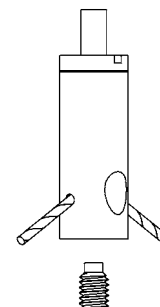

12Z-M4-Q1.6
Cross-Cable Gripper

* Also available with/without safety nut/cap

TYPE-15 GRIPPERS



15-1420*
1/4-20 thread.
Housing & Thread all steel



15-1420-SC
1/4-20 thread
Safety Cap.
Housing & Thread all steel



15-1420-T2
1/4-20 x 0.394"
Steel thread



15-1032
10-32 thread
Housing & Thread all steel



15-1032-T2
10-32 Steel thread



15-14IP-KFC*
1/4IPS thread

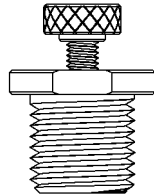

15-14IP-KFT-S*
1/4IPS thread

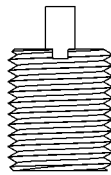

15-14IP-AT*
1/4IPS thread

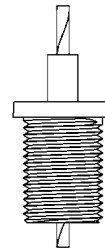

15-18IP-KFT*
1/8IPS thread



15-18IP-AT-1
1/8IPS thread

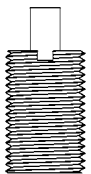

15-18IP-AT
1/8IPS thread



15-18IP-LITO-SC
1/8IPS thread

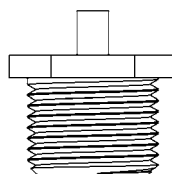

15-38IP-KFT*
3/8IPS thread



15Z-1420i
1/4-20 int. thread
15Z-832i
8-32 int. thread
15Z-M4i
M4 int. thread



15Z-1420i-T2
1/4-20 int. thread
15Z-832i-T2
8-32 int. thread

* Also available with/without safety nut/cap

TYPE-15 GRIPPERS

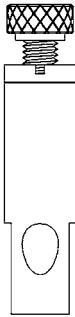

15Z-1420i-KF-S
1/4-20 int. thread
Safety Nut



15Z-1420e-276
1/4-20 x 0.276" thread



15Z-1420e-394
1/4-20 x 0.394" thread



15Z-1032e-R
10-32 x 0.330" thread



15Z-832i-SC
8-32 int. thread
Safety Cap



15Z-832i-SC-T2
8-32 int. thread
Safety Cap

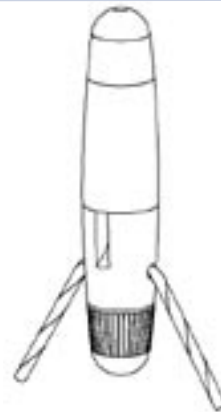

15Z-ELP-M5-Q2.0-SC
Cross-Cable Gripper

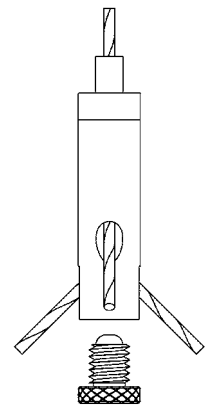

15Z-M6R-SL2.3
Cross-Cable Gripper

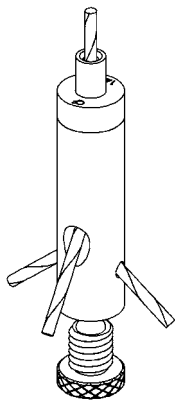

15Z-M6R-Q2.3
Cross-Cable Gripper

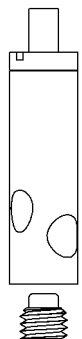

15Z-M5-Q5.5
M5 set-screw incl.



15ZG-M4i
M4 int. thread.
15ZG-1420i
1/4-20 int. thread



15ZG-1420e-315
1/4-20 thread

TYPE-15 GRIPPERS



15-B3
For 3/64" - 1/16" cable
Wood screw incl.

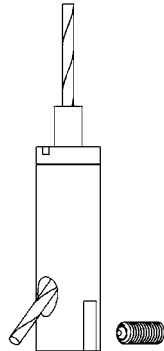

15Z-QM3
0.10" slot. M3 set-screw incl.



15Z-GA
0.15" slot
10-32 set-screw incl.



DG-15Z-TC-300-SAT
Satin-chrome finish. 0.30" slot
10-32 set-screw incl.

LET GRIPLOCK®
DESIGN AND
BUILD A
GRIPPER FOR
YOUR
SPECIFIC
APPLICATION.
CALL OUR
SALES
DEPARTMENT
FOR MORE
INFORMATION

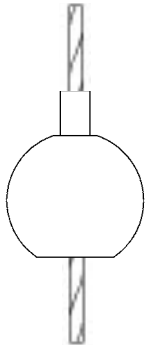

15-K18
Spherical Gripper
Cable exits at bottom



15-K18-RR
Spherical Gripper
Reverse Release

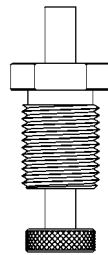

15-18IP-KFT-RR
For 3/64" - 1/16" cable
Reverse Release Gripper



15-M6-RR
Reverse Release
Gripper

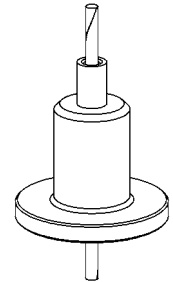

15-B20



15-NT-KFB
E-Clamp incl.

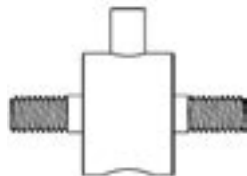

15-1032-2Q
2 x 10-32 nuts incl.

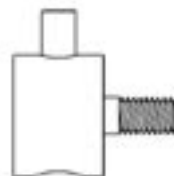

15-1032-Q
10-32 nut incl.

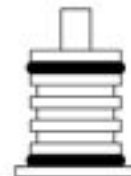

15-5N10
"O" rings incl.



15Z-Q1032
10-32 bolt incl.

TYPE-18 GRIPPERS



18Z-1420i
1/4-20 int. thread

DON'T QUITE
SEE WHAT YOU
NEED? CALL
OUR CUSTOMER
SERVICE
DEPARTMENT.
IF WE HAVE A
SOLUTION, WE
WILL HELP YOU
FIND IT



18Z-1420e-440
1/4-20 x 0.44" thread



18Z-M6-SL2.5
M6 set screw incl.
Cross-Cable Gripper

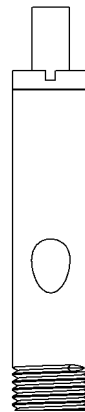

18Z-M10e
M10 thread
M10 nut incl.



18ZG-1420i
1/4-20 int. thread

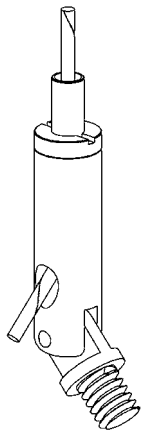

18ZG-1420e-315
1/4-20 x 0.315" thread

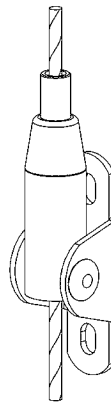

18G
Swivel gripper w/ mounting plate
Also available in satin-chrome

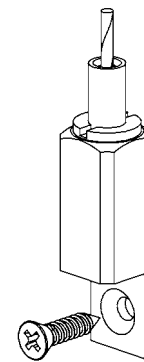

18-B4
Wood screw incl.

*
Also available with safety nut/cap

TYPE-25 GRIPPERS

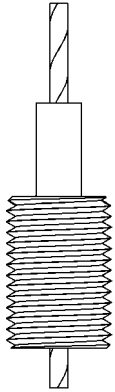

25-14IP-AT
1/4IPS thread

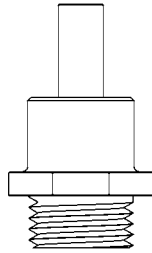

25-14IP-KFC*
1/4IPS thread

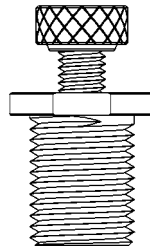

25-14IP-KFT-S*
1/4IPS thread

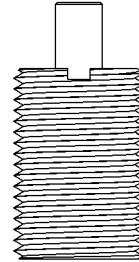

25-38IP-AT*
3/8IPS thread

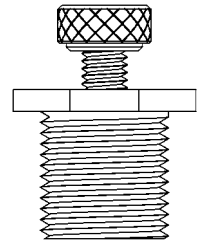

25-38IP-KFT-S*
3/8IPS thread

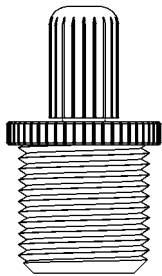

25-38IP-KFT-R-SC*
3/8IPS thread

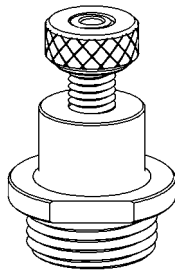

25-38IP-KFC-S*
3/8IPS thread

FULLY
ADJUSTABLE,
GRIPLOCK®
GRIPPERS
PROVIDE THE
SLEEK LOOK
OF CABLE
WITH THE
STRENGTH
OF STEEL



25Z-1420i-S
1/4-20 int. thread
Safety nut



25Z-1420i
1/4-20 int. thread



25Z-M10e
M10 thread
M10 nut incl.

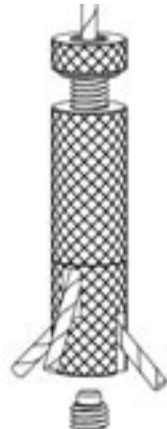

25Z-M6-SL3.0-S
Cross-Cable Gripper
Safety nut
Set-screw incl.

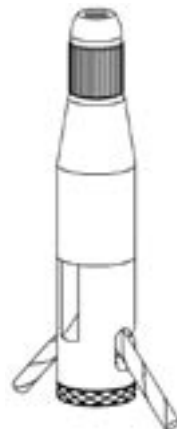

25Z-1420R-SSL-SC
Cross-Cable Gripper
with Side Slot



DG-25-BUL-KFB-SAT
Detachable base plate
Satin-chrome finish

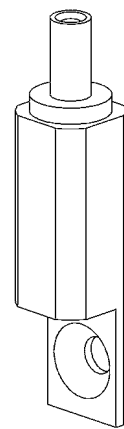

25-B5

*

Also available with/without safety nut/cap

TYPE-30 GRIPPERS

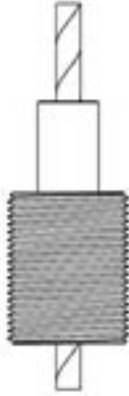

30-M16-AT
M16 x 1.0 thread.
2 x M16 nuts incl.
3-ball mechanism
Safe working load: 200 lbs



30-3816e-V6-S
3/8-16 thread.
6-ball mechanism

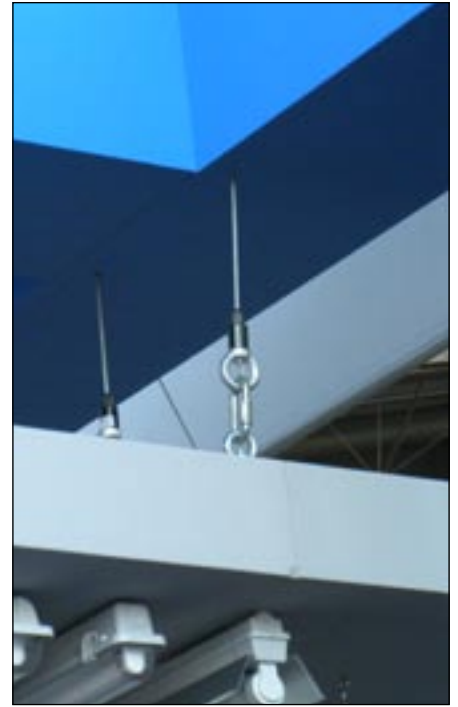

30Z-1420i-V6-S
1/4-20 int. thread.
6-ball mechanism



30ZG-3816i-V6-S
3/8-16 int. thread.
6-ball mechanism



30Z-M6-V6-Q3.5
Cross-Cable Gripper.
6-ball mechanism

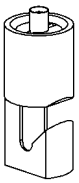

10-HA
"Micro Hook"
For 1/32" - 1.0mm cable

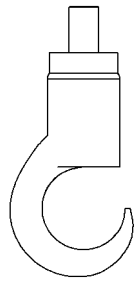

15-HA*
For 3/64" - 1/16" cable

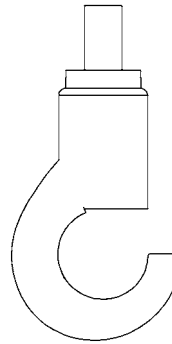

18-HA*
For 1/16" - 5/64" cable



15-GHA
Gated hook
For 3/64" - 1/16" cable



15Z-1420-GHA
Gated Hook
For 3/64" - 1/16" cable



18Z-1420-GHA
Gated Hook
For 1/16" - 5/64" cable



25Z-1420-GHA
Gated hook
For 5/64" - 2.5mm cable

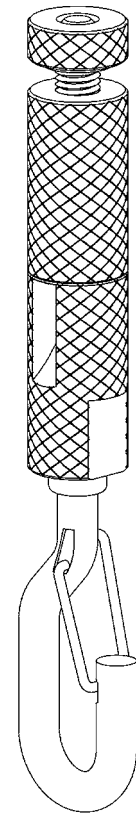

30Z-1420-V6-GHA
Gated Hook.
6-ball mechanism
For 3/32" - 1/8" cable

* Also available with safety nut/cap

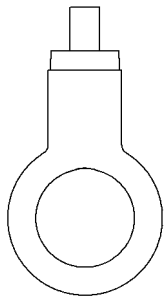

15-RI *
For 3/64" - 1/16" cable

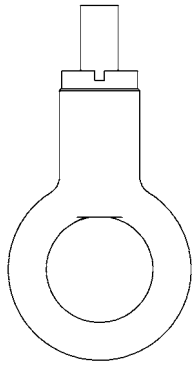

18-RI *
For 1/16" - 5/64" cable



30-RI-V6B-S
For 3/32" - 1/8" cable.
6-ball mechanism
Black zinc plated

30-RI-V6-S
For 3/32" - 1/8" cable.
6-ball mechanism
Nickel plated

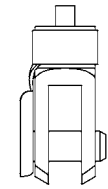
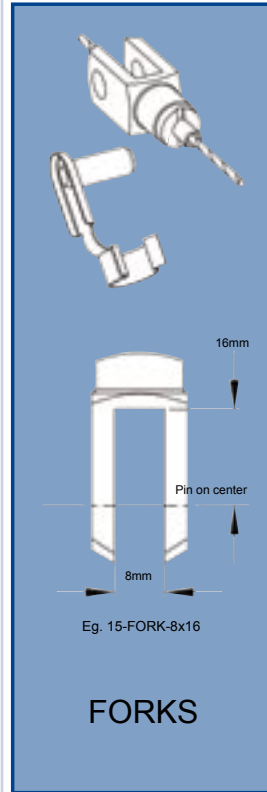

10-FORK-4.3x8
For 1/32" - 1.0mm cable

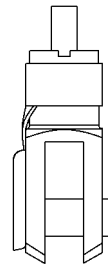

12-FORK-5x10
For 1/32" - 3/64" cable

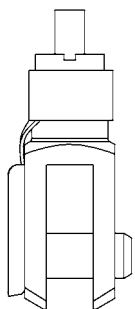

15-FORK-6x12
For 3/64" - 1/16" cable

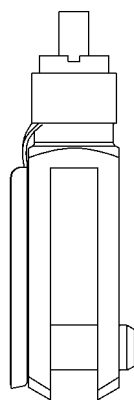

15-FORK-6x24
For 3/64" - 1/16" cable

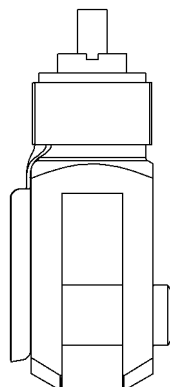

15-FORK-8x16
For 3/64" - 1/16" cable
18-FORK-8x16
For 1/16" - 5/64" cable



25-FORK-6x12-SC
For 5/64" - 2.5mm cable



30-FORK-10x20-V6B-S
For 3/32" - 1/8" cable.
6-ball mechanism
Black zinc plated
30-FORK-10x20-V6-S
For 3/32" - 1/8" cable.
6-ball mechanism
Nickel plated

* Also available with safety nut/cap

POWERFEED AND SPUTNIK ASSEMBLIES

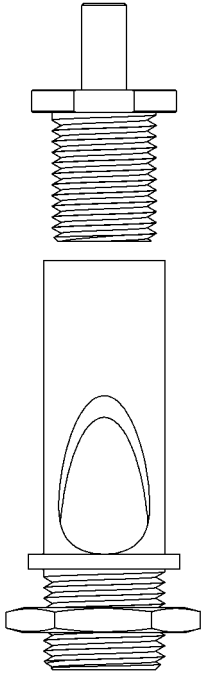

15-38IP-PF
For 3/64" - 1/16" cable
25-38IP-PF
For 5/64" - 2.5mm cable
Accepts cord up to 0.42" in dia.

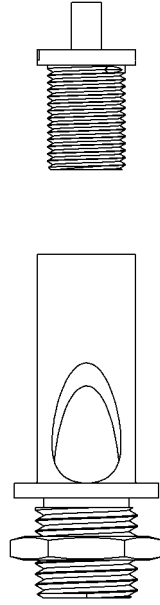

15-14IP-PF
For 3/64" - 1/16" cable
Accepts cord up to 0.325" in diameter

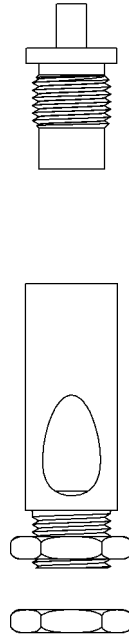

15-M10-PF
For 3/64" - 1/16" cable
Accepts cord up to 0.25" in diameter

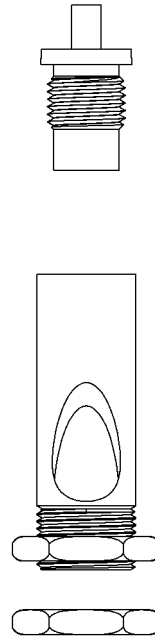

15-M13-PF
For 3/64" - 1/16" cable
Accepts cord up to 0.325" in diameter

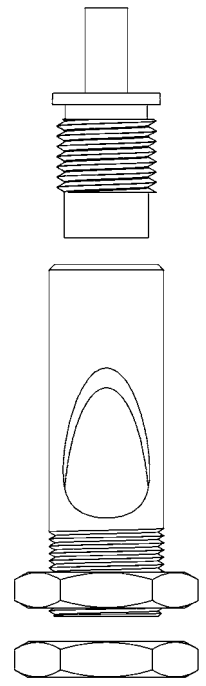

25-M16-PF
For 5/64" - 2.5mm cable
Accepts cord up to 0.42" in diameter



Typical Powerfeed
Assembly with cord & cable

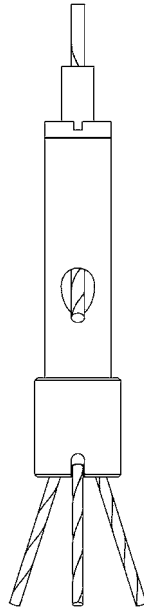

18Z-SPT3
Sputnik assembly for 1/16" and 5/64" cable

25Z-SPT3
Sputnik assembly for 5/64" - 3/32" cable

Cables NOT included

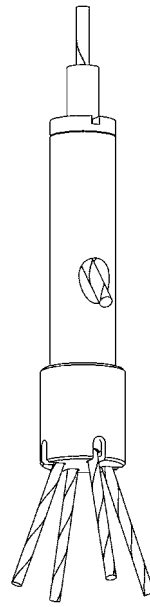

18Z-SPT4
Sputnik assembly for 1/16" and 5/64" cable

25Z-SPT4
Sputnik assembly for 5/64" - 3/32" cable

Cables NOT included



15-SPT3
Sputnik assembly for 3/64" and 1/16" cable

25-SPT3
Sputnik assembly for 5/64" - 3/32" cable

Cables NOT included



15-SPT4
Sputnik assembly for 3/64" and 1/16" cable

25-SPT4
Sputnik assembly for 5/64" - 3/32" cable

Cables NOT included



CC-1420
Cable Coupler
For cable $\leq 3/32"$.
1/4-20 int. thread

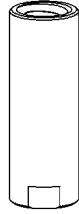

CC-1420-T2
Cable Coupler
For cable $\leq 3/32"$.
1/4-20 int. thread



CC-3816
Cable Coupler
For cable $\leq 3/32"$.
3/8-16 int. thread



CC-181P-SR
Slipping coupler
For cable $\leq 3/32"$.
1/4-20 int. thread
See page 22
US Patent 6,761,342 B1

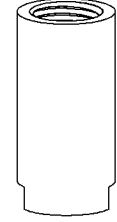

CC-181P
Cable Coupler
For cable $\leq 3/32"$.
1/8IPS int. thread

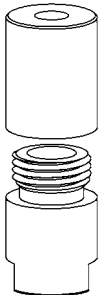

CC-2
2-part Cable Coupler
For cable $\leq 3/32"$

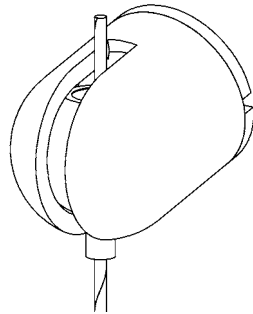

15-BS-1420
Adjustable Sloped
Ceiling Coupler
For 1/16" cable.
1/4-20 int. thread

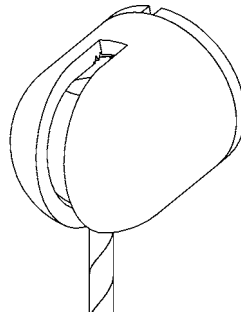

CC-1420-SL4.4
Sloped Ceiling Coupler
For $\leq 1/8"$ cable.
1/4-20 int. thread

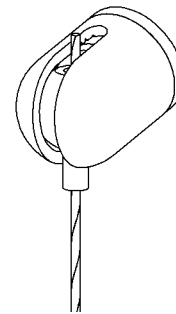

12-BS-1420
Adjustable Sloped
Ceiling Coupler
For 3/64" cable.
1/4-20 int. thread

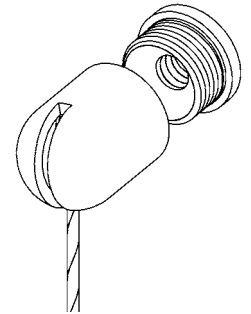

CC-1420-SL2.1
Sloped Ceiling Coupler
For $\leq 5/64"$ cable
CC-1420-SL3.0
For 3/32" cable.
1/4-20 int. thread



CC-SL2.1-SR
Sloped Ceiling Slipping Coupler.
1/4-20 int. thread



15Z-1420-SCC
1/4-20 thread
15Z-1420-SCC-SAT
Satin Chrome finish

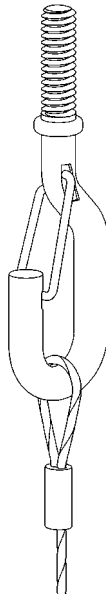

HF-B-1420-GH-313
Large Gated Hook w/
1/4-20 thread

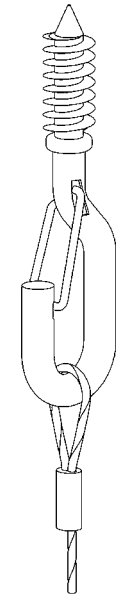

HF-S-GH
Large Gated Hook w/
wood screw

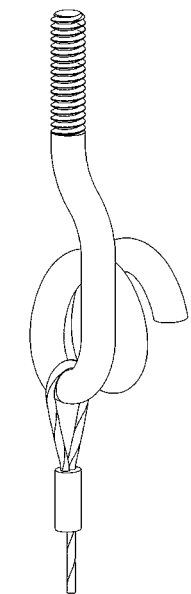

HF-B-1420-PH
Pigtail Hook w/
1/4-20 thread

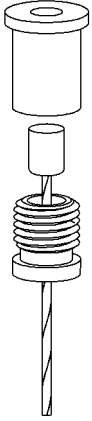

CC-M8
2-part Cable Coupler
For $\leq 1/16"$ cable.

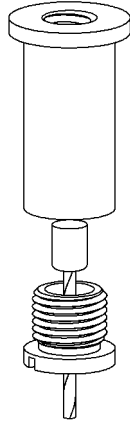

CC-M10-1420
2-part Cable Coupler
1/4-20 int. thread
For $\leq 5/64"$ cable.

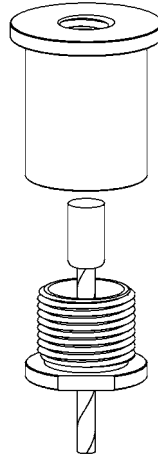

CC-M13-1420-Q2.4
2-part Cable Coupler
1/4-20 int. thread
For $\leq 5/64"$ cable.

CC-M13-1420-Q3.5
For $\leq 1/8"$ cable.



CC-1420-ELP
2-part Cable Coupler
1/4-20 int. thread
For $\leq 3/32"$ cable.

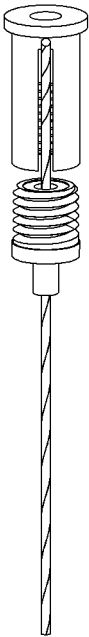

12Z-M8-SL
2-part adjustable Cable Coupler
For $1/32"$ - $3/64"$ cable.



15Z-M10-1420-SL
2-part adjustable Cable Coupler
1/4-20 int. thread
For $3/64"$ - $1/16"$ cable.

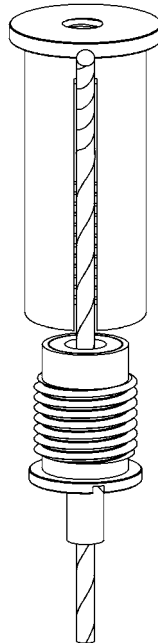

25Z-M13-1420-SL
2-part adjustable Cable Coupler
1/4-20 int. thread
For $5/64"$ - $3/32"$ cable.

20Z-M13-1420-SL
For $1/16"$ and $5/64"$ cable.

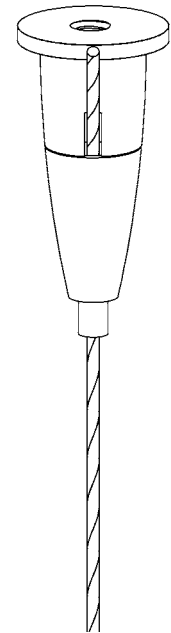

15Z-1420-ELP
2-part adjustable Cable Coupler
1/4-20 int. thread
For $3/64"$ - $1/16"$ cable.

GRIPLOCK® INDUSTRIAL / CABLEFAST®

The opposite page shows our range of Griplock®-designed, lower cost Industrial or “ZF” grippers. Every ZF gripper is visually inspected and its mechanism tested for function. A high percentage are tested to destruction. Type-25 ZF grippers are not recommended for use with 1/16” (or smaller diameter) cable. Type-30 ZF grippers are not recommended for use with 5/64” (or smaller diameter) cable. Griplock® Systems recommends a lower Safe Working Load (SWL) for these grippers than its other products. See pages 28 and 29.

INDUSTRIAL CABLING KITS

The movement towards energy conservation, tax incentives for retrofits, and new construction is changing the Industrial lighting landscape nationwide. Griplock® Systems is here to help manufacturers and installers keep pace and stay competitive. We offer a popular range of well-priced industrial cabling kits that make a week on a cherry picker just that much easier and a lot more efficient. And just as importantly, you’ve got to know that when you buy a Griplock® Industrial kit, our reputation for safety and quality is there in every bag. The key components of these suspension systems are ZF grippers, shown below and on the next three pages.



The **ZF-15ZZ** double-ended Pushmepullyu gripper handles loop-over applications: unistrut, pipes, beams, purlins, roof trusses, HVAC duct etc. It has an SWL* of 75 lbs in these applications**.

The **ZF-15Z-1420i** Ceiling Gripper has an internal ¼-20 thread to attach to unistrut, hanger bolts, threaded studs & anchors, etc. It can be used at the structure or the fixture. It has an SWL* of 50 lbs.

The **ZF-15Z-VC** V-Clip gripper has a SWL* of 50 lbs. Top-mount and side-mount V-Clips are not included in these kits but are available from Griplock® Systems.

The **ZF-15Z-XC** X-Cable gripper is for applications where fixture height adjustment is easier made at the fixture and where fixture balance may be a problem. The toggle-ended X-cable slides through the gripper and can be locked off at the optimum balance point. It has an SWL* of 50 lbs.

ZF grippers are hand-adjustable and do not require tools. There is no minimum weight needed to keep the mechanism locked, and, most importantly, you cannot release the mechanism while there is any weight at all on the system.

All stock Griplock® Industrial kits include 1/16” galvanized cable. Other cable formats are available but are not necessarily stock items and may require a lead time. Non-stock cable diameters available are: 5/64”, 3/32”, 1/8”, galvanized and stainless steel 304 and 316.

Assemblies are usually packaged two to a bag.

* SWL = Safe Working Load when used in a loop-over or loop-under application.

**When the Pushmepullyu is used to join 1/16” cables IN SERIES, SWL is reduced to 50lbs.

GRIPLOCK® SYSTEMS: READY WHEN YOU ARE!

GRIPLOCK® INDUSTRIAL / CABLEFAST®

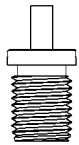

ZF-12-M8-KFT
For 3/64" cable only
M8x1 thread
Lock nut incl.

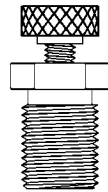

ZF-15-18IP-KFT-S
For 3/64" - 1/16" cable

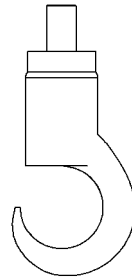

RT-15-HA
For 3/64" - 1/16" cable
Working Load: 30 LBS max

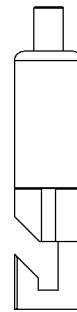

ZF-15-HA
Slim hook
For 3/64" - 1/16" cable
Working Load: 30 LBS max.

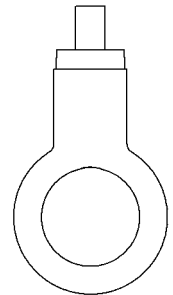

ZF-15-RI
For 3/64" - 1/16" cable



ZF-15Z-VC
For 3/64" - 1/16" cable
V-Clip Gripper

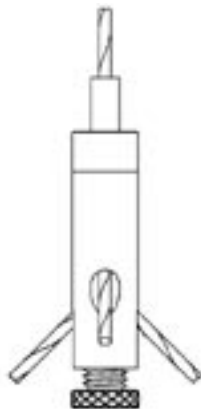

ZF-15Z-XC
For 3/64" - 1/16" cable
Cross-Cable Gripper



ZF-15ZZ
For 3/64" - 1/16" cable
Pushmepullyu



ZF-15Z-1420i
For 3/64" - 1/16" cable
Ceiling Gripper

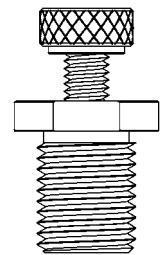

ZF-25-14IP-KFT-S
For 5/64" - 2.5mm cable



ZF-25-38IP-KFT-R-S
For 5/64" - 2.5mm cable



ZF-25-38IP-KFT-S
For 5/64" - 2.5mm cable

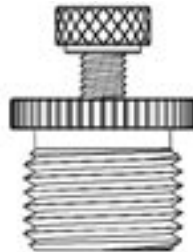

ZF-25-12IP-KFT-R-S
For 5/64" - 2.5mm cable

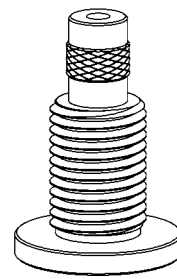

ZF-25-14IP-KFB-SC
For 5/64" - 2.5mm cable



ZF-30ZZ
For 3/32" - 1/8" cable
Pushmepullyu
Also available in Black



Y-CABLES

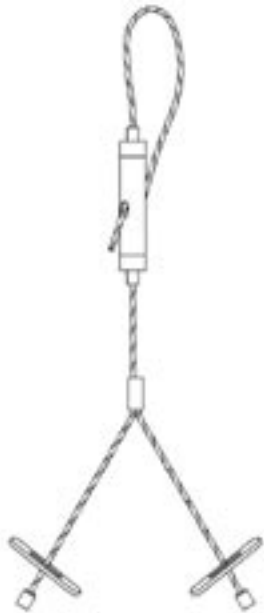

G-16Ya-ZZ-TG-xxx



ZZ
Pushmepullyu

CEILING ATTACHMENTS



15Z
Ceiling Gripper

15Z
Threads to
1/4-20 ceiling
studs, etc.

Don't see quite what
you need? Call us,
and we will find a
part which will work
with your application

FIXTURE ATTACHMENTS



TG
Toggle



GHK
Small Gated Hook



87
Barrel Terminal

TG
Toggles fit
1/4" - 5/16"
diameter holes

G-16Ya-b-c-xxx: a = leg length, b = ceiling attachment, c = fixture attachment, xxx = overall length.

X-CABLES



G-16XCa-15Z-44-TG-xxx

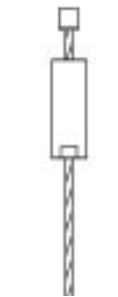

CC
Cable Coupler

CEILING ATTACHMENTS



44
Loop



TG
Toggle



GHK
Small Gated Hook

FIXTURE ATTACHMENTS



TG
Toggle

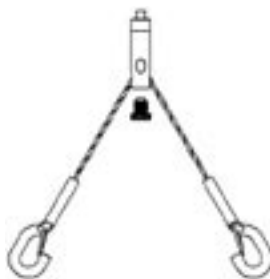

GHK
Small Gated Hook



44
Loop

CC
Threads to
1/4-20 ceiling
studs, etc.

GHK
Fits 1/4" ID Ceiling
clip, eyes, etc.

G-16XCa-b-c-xxx: a = total X-cable length, b = ceiling attachment, c = fixture attachment, xxx = primary cable length

SINGLE CABLES



G-AG16-CC-1420-xxx

G-AG16-a-b-xxx: a = ceiling attachment, b = fixture attachment, xxx = overall length

CEILING AND FIXTURE ATTACHMENTS



CC
Cable Coupler



44
Loop



ZZ
Pushmepullyu



GHK
Small Gated Hook



GHCC
Large Gated Hook



TG
Toggle



15Z
Ceiling Gripper



1420
1/4-20 Stud

V-CLIP CABLES



G-AG16-V-44-xxx

G-AG16-V-a-xxx: a = ceiling attachment, xxx = primary cable length

CEILING ATTACHMENTS



CC
Cable Coupler



GHK
Small Gated Hook



44
Loop



TG
Toggle

FIXTURE ATTACHMENTS



SM
Side Mount V-Clip



TM
Top Mount V-Clip

V-Clips
Not supplied with kits but are available from Griplock

CC
Threads to 1/4-20 ceiling studs, etc.

KITS SOLD WITHOUT GRIPPERS

Cables are available in galvanized or stainless steel.
Grippers ordered separately

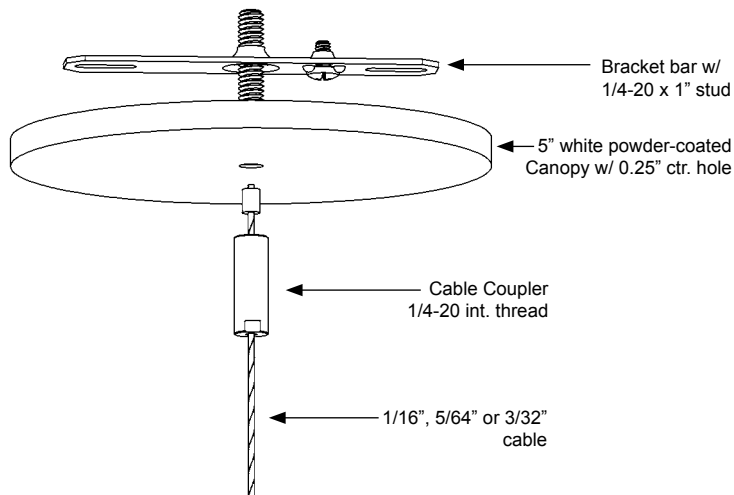

NON-POWERFEED KITS - PACKAGED

G-AG16-Q5-xxx 1/16" galv. cable

G-AG20-Q5-xxx 5/64" galv. cable

G-AG24-Q5-xxx 3/32" galv. cable

Available in black. Eg: G-AG16-Q5B-xxx

xxx = Cable length in inches

Stock lengths: 24", 48", 96", 120", 150", 180" & 240"

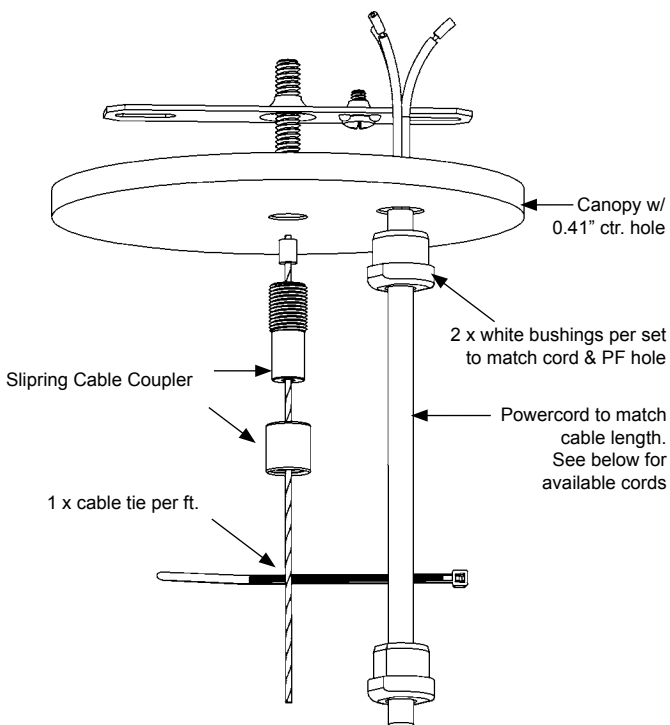

STRAIGHT CORD KITS - PACKAGED

G-AG16-PF183-xxx 1/16" galv. cable

G-AG20-PF183-xxx 5/64" galv. cable

G-AG24-PF183-xxx 3/32" galv. cable

Available in black. Eg: G-AG16-PF183B-xxx

xxx = Cable length in inches

Stock lengths: 24", 48", 96", 120", 150", 180" & 240"

Stock white powercord: 18/3 (PF183), 18/4 (PF184), 18/5 (PF185), 18/6 (PF186), 14/3 (PF143), 14/4 (PF144), 12/3 (PF123) & 12/4 (PF124)

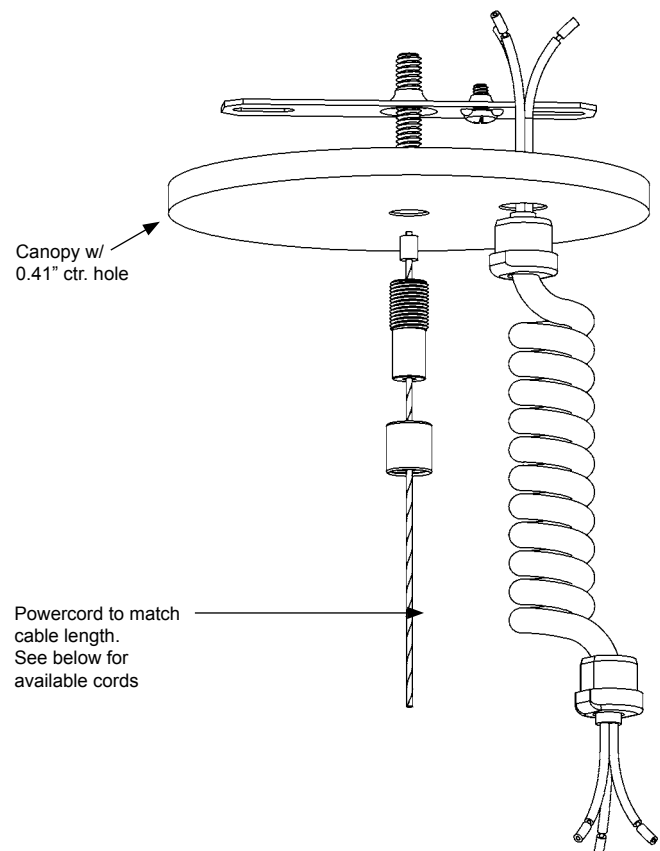

COIL CORD KITS - PACKAGED

G-AG16-PFC183-xxx 1/16" galv. cable

G-AG20-PFC183-xxx 5/64" galv. cable

G-AG24-PFC183-xxx 3/32" galv. cable

xxx = Cable length in inches

Stock lengths: 24", 48", 96" & 120" only.

Stock white coil cord: 18/3 (PFC183) & 18/4 (PFC184)

KITS SOLD WITHOUT GRIPPERS

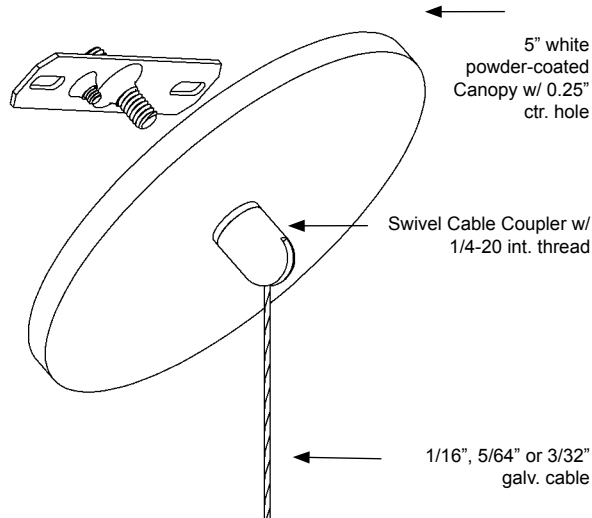

Cables are available in galvanized or stainless steel.
Grippers ordered separately

NON-POWERFEED KITS - PACKAGED

G-AG16-SL-Q5-xxx 1/16" galv. cable

G-AG20-SL-Q5-xxx 5/64" galv. cable

G-AG24-SL-Q5-xxx 3/32" galv. cable

Available in Black. Eg: G-AG16-SL-Q5B-xxx

xxx = Cable length in inches

Stock lengths: 24", 48", 96", 120", 150", 180" & 240"

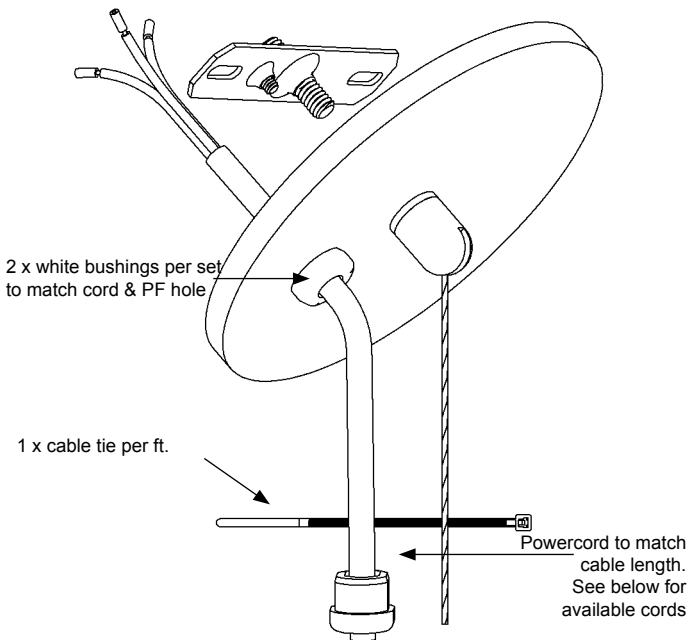

STRAIGHT CORD KITS - PACKAGED

G-AG16-SL-PF183-xxx 1/16" galv. cable

G-AG20-SL-PF183-xxx 5/64" galv. cable

G-AG24-SL-PF183-xxx 3/32" galv. cable

Available in Black. Eg: G-AG16-SL-PF183B-xxx

xxx = Cable length in inches

Stock lengths: 24", 48", 96", 120", 150", 180" & 240"

Stock white powercord: 18/3 (PF183), 18/4 (PF184), 18/5 (PF185), 18/6 (PF186), 14/3 (PF143), 14/4 (PF144), 12/3 (PF123) & 12/4 (PF124)

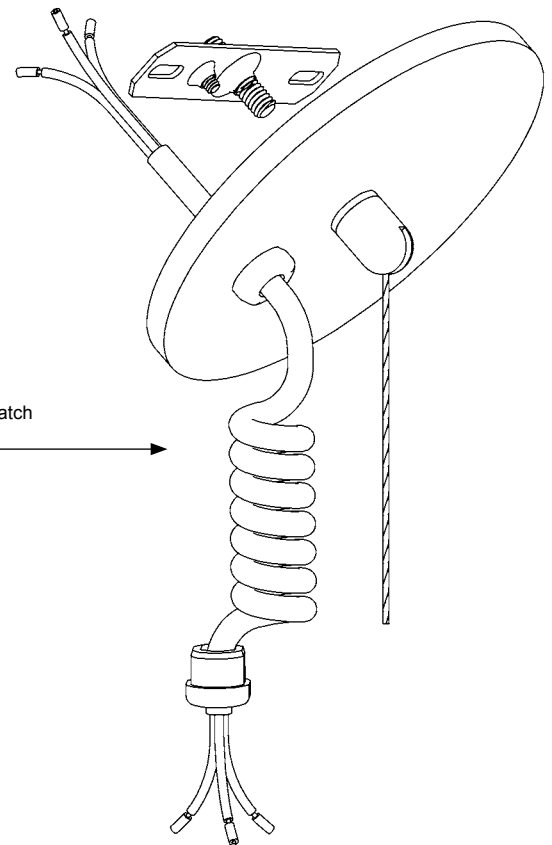

COIL CORD KITS - PACKAGED

G-AG16-SL-PFC183-xxx 1/16" galv. cable

G-AG20-SL-PFC183-xxx 5/64" galv. cable

G-AG24-SL-PFC183-xxx 3/32" galv. cable

Available in White only.

xxx = Cable length in inches

Stock lengths: 24", 48", 96" & 120" only.

Stock coil cord: 18/3 (PFC183) & 18/4 (PFC184)

STOCK CABLES, SLEEVES & TERMINALS



80 sleeve
3/64" stainless cable only
0.19" dia.



87 sleeve
3/64" - 5/64" cable only
0.19" dia.



01 sleeve (Swaged)
71 sleeve (Die-cast)
3/32" cable only
0.19" dia.

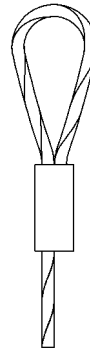

44
Loop

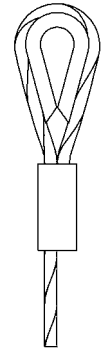

45
Loop/Thimble

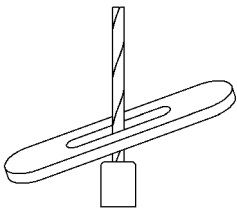

TG
Toggle sleeve
3/64" - 5/64"
cable only



1420CC
1/4-20 stud
1/4-20 thread

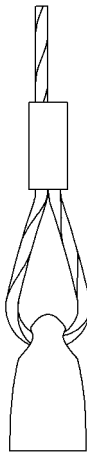

ST
Swivel Terminal
1/4-20 int. thread



GHK
60°, 120°, 180°, & 240°
1/16" galvanized cable only



GHCC
Gated Hook

STOCK CABLE SIZES: 3/64", 1/16", 5/64" & 3/32" unless noted
 STOCK CABLE LENGTHS: 24", 48", 96" 120", 150", 180" & 240" unless noted
 STOCK CABLE TYPE: 7 X 7 galvanized & stainless unless noted. 1/8" & up: 7 X 19

NON-STOCK CABLES, SLEEVES & TERMINALS

PLEASE CONSULT US FOR MORE INFORMATION ON SWAGED & MOLDED TERMINALS. MANY MORE ARE AVAILABLE THAN CAN BE SHOWN ON THIS PAGE. CUSTOM DESIGNS ARE ALSO AVAILABLE. CABLES ARE MADE EXCLUSIVELY OF MEDIUM-TO-HIGH-TENSILE STRENGTH AIRCRAFT CABLE.



73 sleeve
3/64" cable.
0.12" dia.

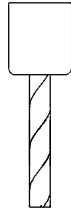

10 sleeve
1/8" cable.
0.34" dia.



91 sleeve
3/64"-1/8" cable
Various diameters



93 sleeve
3/64"-1/8" cable
Various diameters

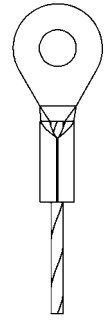

Stake-Eye 99
Stainless **99S**
All cables

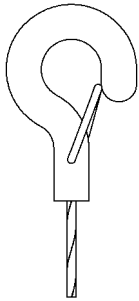

GHKZ
3/16" cable only
25lbs. MAX.
STATIC LOAD



02 sleeve
3/64"-1/16" cable.
0.24" dia.

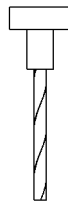

16 sleeve
1/32"-1/16" cable.
0.32" dia.

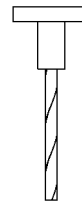

17 sleeve
1/16" cable.
0.39" dia.

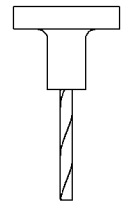

18 sleeve
1/16" cable.
0.55" dia.

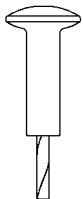

11 sleeve
1/32"-1/16" cable.
0.38" dia.

**TERMINALS ARE
GUARANTEED
TO THE FULL
PUBLISHED
BREAK
STRENGTH OF
THE CABLE
UNLESS NOTED**



1032
10-32 swaged stud
3/64"-1/16" cable



1420
1/4-20 swaged sleeve
3/64"-1/16" cable



GH
1/8" cable

NON-STOCK CABLE: If cables in need to be manufactured there may be a lead time of up to 10 weeks depending on the type & quantity. For orders of <5 cables in non-stock lengths and/or with non-stock terminals a \$10.00 per cable charge will be imposed. < 10 cables: \$5.00. < 50: \$2.50 per cable. < 100: \$1.00 per cable. For cables that need to be cut down to a specific non-stock length there will be a charge for the next available stock length up, in addition to a \$1.00 cut/tin charge. A custom-cable set up charge may also be imposed.



HX-T-CLIP-Q6-W
T-Bar clip for hook attachment
See pg 25 for **GHKZ** hook

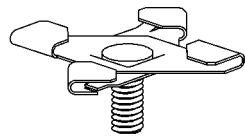

HX-T-CLIP-BAX-4-16-W
Scissor T-Bar clip
5/8" x 1/4-20 stud

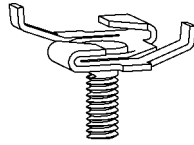

HX-T-CLIP-BA-4-16-W
"Twist-on" T-Bar clip
5/8" x 1/4-20 stud

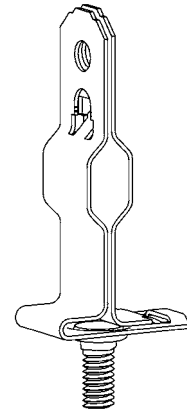

HX-T-CLIP-BAI
Wrap-around T-Bar clip
5/8" x 1/4-20 stud

NEW!



HX-T-CLIP-KEY-W
T-Bar clip for **80** ball terminal
See page 25



HF-STAY
White/black/grey/clear



HF-STAY-M4
White/black/grey/clear
M4 set-screw incl.

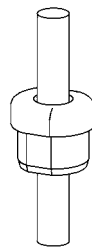

HEYCO
Strain relief
bushings

BUSHING - PF HOLE - POWERCORD CHART

Cord Type	Dia.	PF Dia.	Griplock® p/ns (Blk./Wht.)	
18/3 SVT	0.26"	0.500"	SR-1150-B	SR-1151-W
18/3 SJT	0.35"	0.625"	SR-1200-B	SR-1201-W
18/4 AWM	0.29"	0.625"	SR-1200-B	SR-1201-W
18/4 SJT	0.35"	0.625"	SR-1200-B	SR-1201-W
18/5 SJT	0.40"	0.875"	SR-1247-B	SR-1248-W
18/6 SJT	0.43"	0.875"	SR-1247-B	SR-1248-W
14/3 SJT	0.38"	0.875"	SR-1247-B	SR-1248-W
14/4 SJT	0.41"	0.875"	SR-1247-B	SR-1248-W
12/3 SJT	0.43"	0.875"	SR-1247-B	SR-1248-W
12/4 SJT	0.47"	0.875"	SR-1497-B	SR-1498-W

5" CEILING CANOPIES

Q5-14 series

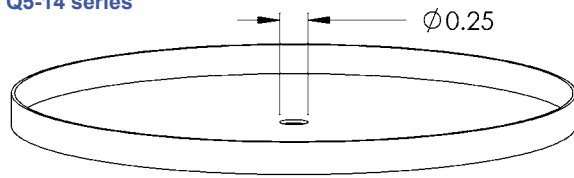

Q5-410 series

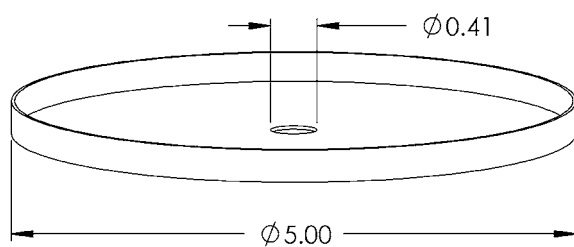

2" CEILING CANOPIES

Q2-14-W

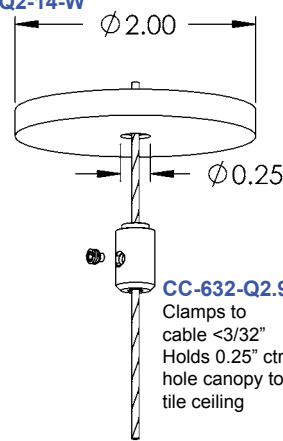

CC-632-Q2.9
Clamps to
cable <3/32"
Holds 0.25" ctr.
hole canopy to
tile ceiling

STOCK CEILING CANOPIES - WHITE

Also available in black and unfinished, but may not be in stock. (UV resistant)

Griplock® P/N	OD	Ctr. hole	PF Hole
Q2-14-W	2"	0.25"	N/A
Q5-14-W	5"	0.25"	N/A
Q5-14-W-500	5"	0.25"	0.500"
Q5-14-W-625	5"	0.25"	0.625"
Q5-14-W-875	5"	0.25"	0.875"
Q5-14-W-1125	5"	0.25"	1.125"
Q5-410-W	5"	0.41"	N/A
Q5-410-W-500	5"	0.41"	0.500"
Q5-410-W-625	5"	0.41"	0.625"
Q5-410-W-875	5"	0.41"	0.875"



CC-M8-SL2.4
Cross-Cable connector



CC-M8-Q2.9
Cross-Cable connector

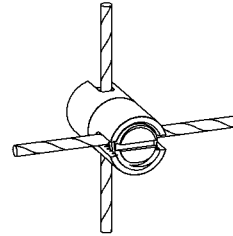

CC-UNICROSS
Connects any two cables at any angle. See page 31



TL-Cutter
Felco-Type Cable Cutter

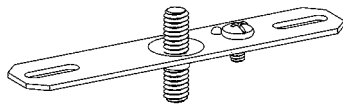

BB-1420-1
Bracket bar for 4" J-box
1/4-20 x 1" stud

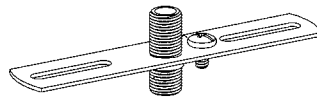

BB-18IP-1
Bracket bar for 4" J-box
1/8IPS x 1" stud



CC-M4-Q2.2
Screw-on terminal for
3/64" - 5/64" cable
NOTE: 10lbs Max. static load

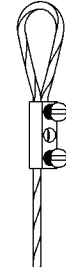

CC-M3x2-Q3.2
Loop-maker for 3/64" & 1/16" cable
NOTE: 25lbs Max. static load

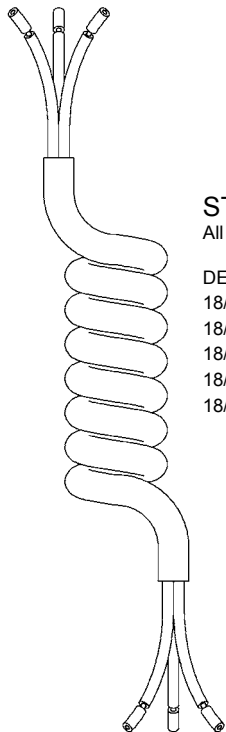

STOCK COIL CORDS

All stock coil cords are white

DESCRIPTION	EXT.	Griplock® P/N
18/3 SVT 16" Ret.	48"	EC-183-SVT-W-16
18/3 SVT 24" Ret.	72"	EC-183-SVT-W-24
18/3 SVT 42" Ret.	126"	EC-183-SVT-W-42
18/4 AWM* 16" Ret.	48"	EC-184-AWM-W-16
18/4 AWM* 24" Ret.	72"	EC-184-AWM-W-24

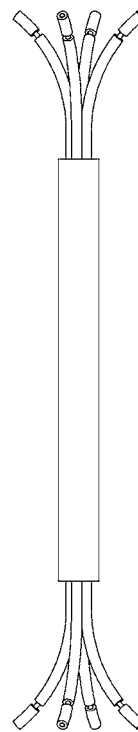

STOCK STRAIGHT CORDS

Black powercords are also available but may not be in stock

DESCRIPTION	Griplock® P/N
18/3 SVT	ES-183-SVT-W-xxx
18/4 AWM*	ES-184-AWM-W-xxx
18/3 SJT	ES-183-SJT-W-xxx
18/4 SJT	ES-184-SJT-W-xxx
18/5 SJT	ES-185-SJT-W-xxx
18/6 SJT	ES-186-SJT-W-xxx
14/3 SJT	ES-143-SJT-W-xxx
14/4 SJT	ES-144-SJT-W-xxx
12/3 SJT	ES-123-SJT-W-xxx
12/4 SJT	ES-124-SJT-W-xxx

INSTRUCTIONS FOR USE

Except where noted, grippers and couplers in this catalog are of nickel-plated brass. Other finishes such as satin-chrome are available but may not be in stock. For detailed line drawings, illustrations and application examples please visit our website or contact us.

IF THIS IS THE FIRST TIME YOU'VE WORKED WITH GRIPLOCK® GRIPPERS, PLEASE READ THE FOLLOWING INFORMATION CAREFULLY:

- Use only 7x7 or 7x19 uncoated galvanized or stainless steel aircraft cable.
- When feeding cable through a gripper always allow cable to pass 1" beyond the gripper housing. When cutting excess cable always leave 1" of cable showing.
- Cable should be cut using purpose-built cutters as shown on page 27.
- Cable will not fray when cut unless passed repeatedly through the Griplock® mechanism or otherwise overworked. In this case trim the cable and/or apply a drop of super-glue.
- DO NOT ATTEMPT TO RUN AN ELECTRICAL CURRENT THROUGH THESE CABLES. Use a separate power cord. For information on our Low Voltage Conductive Cables see page 2.
- DO NOT feed excess cable into a fixture housing or junction box containing electrical wiring.
- Adhere strictly to the Weight Load Guidelines on page 29. Use only cable and gripper combinations for which a minimum break strength has been specified, eg. 1/16" cable with Type-15 gripper.
- The Griplock® system is generally not recommended for permanent outdoor installations. It should not be exposed to wind or water or allowed to oscillate continuously. Avoid placing fixtures in chemical-laden environments such as indoor swimming pools (for more information on these applications please call our office). Do not place unbraced fixtures close to HVAC vents where they may be exposed to continual air currents. If in any doubt consult a Griplock engineer or sales representative.
- Cables should not enter or exit couplers, grippers or tensioners at more than a 5° angle (see illustration below). For angled applications use the jointed grippers and couplers shown on pages 8, 10, 12, 16 & 23.



WEIGHT CHARTS

The information in these charts shows minimum break strengths for Griplock® and “ZF” grippers using 7x7 galvanized aircraft cable. Use of Griplock® supplied cables is assumed. Type-25 ZF grippers are designed for 3/32” and 5/64” cable only.

The information in these charts is not applicable to any other cable gripping product. Weight load guidelines and other specifications are for illustration purposes only. They should not be construed as a warranty that the product or system will conform. Each purchaser is solely responsible for determining that (1) the product and/or system is suitable for the intended application, and (2) the product and/or system complies with all federal, state and local safety and trade laws and regulations.

End-users are cautioned that the integrity of the structures to which these components are attached and the fasteners used to attach them are critical to the integrity of the overall system and should therefore be evaluated by a qualified engineer or installer.

The Following Figures are for Griplock® Grippers Only.
Please refer to the ZF Gripper chart below for ZF Gripper figures.

Minimum Break Strength for Griplock® Grippers and High Tensile Galvanized Cable in Pounds.									
		Gripper Type							
Cable Diameter	Inches	Mms.	Type-10	Type-12	Type-15	Type-18	Type-25	Type-30	SWL*
			3-Ball	3-Ball	3-Ball	3-Ball	3-Ball	6-Ball	
MINIMUM BREAK STRENGTH									1:5 Ratio
	1/32”		67						13
		1.0 mm	112	112					22
	3/64”	1.2 mm		165	165				33
		1.5 mm			280	280			56
	1/16”	1.6 mm			300	300			60
	5/64”	2.0 mm				450	450		90
	3/32”	2.4 mm					630	630	126
		2.5 mm					674	674	134
		3.0 mm						1012	200
	1/8”							1125	225

The Following Figures are for ZF Grippers Only.
Please refer to the above chart for Griplock® Gripper figures.

Minimum Break Strength for ZF Grippers and High Tensile Galvanized Cable in Pounds.						
		Gripper Type				
Cable Diameter	Inches	Mms.	Type-12	Type-15	Type-25	SWL*
			MINIMUM BREAK STRENGTH			1:5 Ratio
	3/64”	1.2 mm	125	125	DO NOT use with 3/64” cable	25
	1/16”	1.6 mm		200	DO NOT use with 1/16” cable	50
	5/64”	2 mm			325	65
	3/32”	2.4 mm			475	95

* SWL = Safe Working Load

GRIPLOCK® CABLES

Griplock Standard Size Cables And Their Metric Equivalents	
Cable Diameter	
Inches	Mms
1/32"	
	1.0 mm
3/64"	1.2 mm
	1.5 mm
1/16"	1.6 mm
5/64"	2.0 mm
3/32"	2.4 mm
	2.5 mm
	3.0 mm
1/8"	
	4.0 mm
3/16"	
	5.0 mm
5/16"	8.0 mm



Griplock® Cables are 7x7 or 7x19 galvanized or stainless steel medium-to-high tensile strength aircraft cable and are factory fitted with a variety of sleeves and terminals of die-cast zinc, swaged aluminum, swaged copper or swaged steel. Griplock® sleeves and terminals are guaranteed to the full published break-strength of the cable, however, when used in conjunction with grippers, cables will have a break strength that is less than the break strength of the cable alone. Please refer to the Installation and Weight Load Guidelines on pages 28 and 29.

In all cases Griplock® recommends a static Safe Working Load (SWL) of no more than 1/5 of the minimum break strength of the gripper/cable combination.

General Information					
Thread and Knock Out (KO) Sizes					
Thread Size	Thread Diameter	Fixture KO Sizes	Thread Size	Thread Diameter	Fixture KO Size
1/8IPS = 1/8-27 NPSM	3/8"	7/16"	M4	5/32"	3/16"
1/4IPS = 1/4-18 NPSM	1/2"	9/16"	M6	4/32"	1/4"
3/8IPS = 3/8-18 NPSM	5/8"	11/16"	M8	5/16"	3/8"
1/2IPS = 1/2-14 NPSM	13/16"	7/8"	M10	3/8"	7/16"
10-32	.09"	3/16"	M13	1/2"	9/16"
1/4-20	.24"	1/4"	M16	5/8"	11/16"
3/8-16	.38"	7/16"	M20	25/32"	13/16"

PROPRIETARY AND CONFIDENTIAL: The drawings and specifications contained in this publication are the exclusive property of Griplock® Systems, LLC and shall not be divulged, reproduced, copied or used as the basis for the manufacture or sale of apparatus without the express written authorization of Griplock® Systems, LLC.

GRIPLOCK® SEISMIC BRACING SYSTEM

Longitudinal and lateral 3/32" cables run from wall to wall, intersecting vertical & horizontal cables close to the fixture. There is an adjustable gripper at either end so bulk 3/32" cable can be used. Use 25Z-M13-1420-SL gripper & coupler combo for cables that run perpendicular to wall surfaces, or 25Z-1420-GHA gripper & hook combo for all wall surfaces including angles. Other options available, but not illustrated.

25Z-1420-GHA
Hooks to eye-bolt at any angle
Eye-bolt by others

25Z-M13-1420-SL
combo at each end of
of 3/32" cable
For 90° wall/cable
interface.

CC-UNICROSS locks any
two cables at any angle
See page 27

25Z-1420-GHA
Hooks to eye-bolt
at any angle

Eye bolt (by others)
attaches to
structure

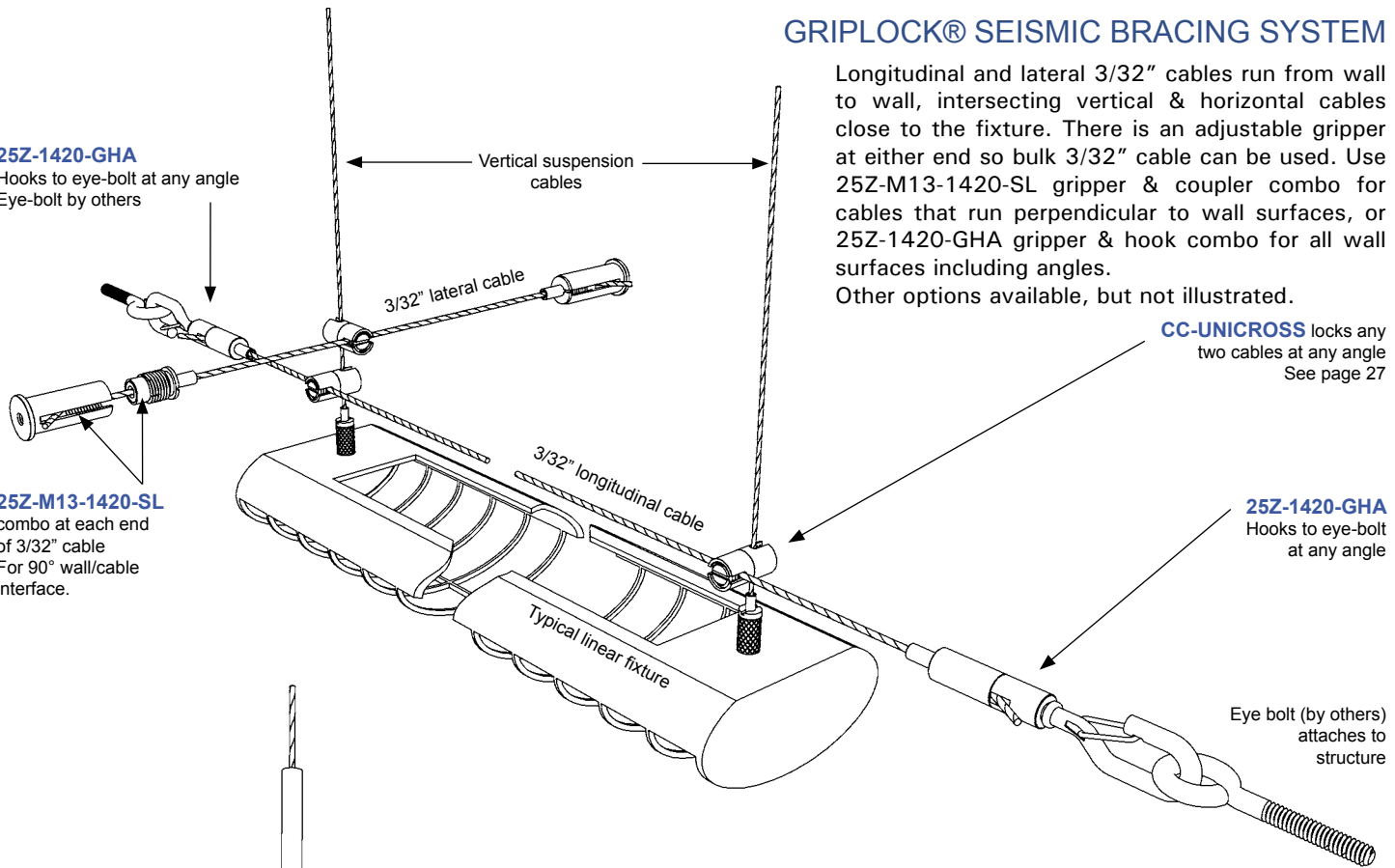

GRIPLOCK® LIGHTING TRACK SYSTEM & TRACK STABILIZER

w/ **15Z-832-SR-8** gripper & **Stabilizing Rod** for cable-hung Track Lighting.

Designers and electrical contractors understand that cable-hung Lighting Track can become unstable due to an imbalance caused by the attached lamps. Some manufacturers offer add-on stabilizing systems to prevent this. Griplock® Systems offers the "Track Stabilizer". An 8" nickel-plated stem screws down onto the threaded plunger of our modified track-suspension gripper. This not only locks down the cable-gripping mechanism but allows the cable to leverage an off-balance track back to its correct position.

15Z-832-SR-8
Kit includes gripper,
rod & 8-32 bolt

Cable Coupler & cable
combo p/n
CC-1420-T2
AG-16-87-xxx

15Z-832i-T2
Gripper only
8-32 bolt incl.

Typical lighting
track

