

DRAWINGS NOT TO SCALE

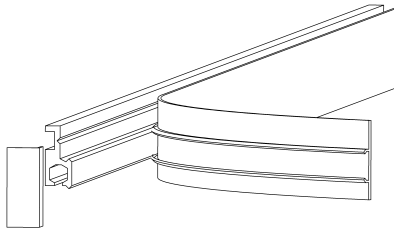

Track, cover & end-cap

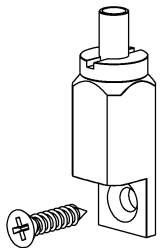

15-B3



Cable w/ ball

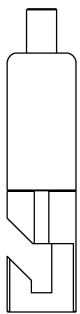

ZF-15-HA

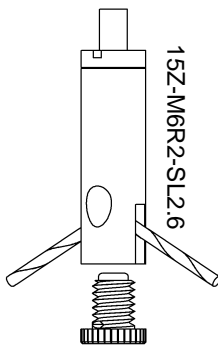

15Z-M6R2-SL2.6

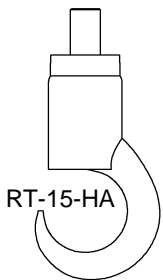

RT-15-HA

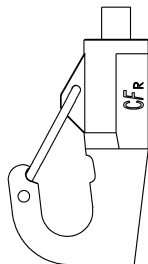

ZF-15-GHA



15-RI

Griplock P/N	Cat. Item/ Page	Description	Qty.	Price	Ext. Price
<b>ART TRACK</b> Deck screws included. Paintable and UV resistant.					
RT-TRAC-80	p.2	Aluminum Art Track. 80" lengths Can be cut to desired length		26.00	
RT-COVER-82	p.2	White PVC Track Cover. Pre-cut 82" lengths		Incl.	
RT-COVER	p.2	White PVC Track Cover. Continuous Roll (Ships separately)		Incl.	
RT-ENDCAPS	p.2	Wht. PVC End-caps. Each		0.60	
<b>CABLES</b> All cables are 3/64" diameter, stainless steel with a ball terminal on one end.					
<b>NOTE:</b> Cable terminals have changed from those shown in our brochure. See adjacent drawings					
AS-12-80-36	p.2	36" length		2.15	
AS-12-80-48	p.2	48" length		2.35	
AS-12-80-60	p.2	60" length		2.55	
AS-12-80-72	p.2	72" length		2.75	
AS-12-80-84	p.2	84" length		2.95	
AS-12-80-96	p.2	96" length		3.15	
AS-12-80-120	p.2	120" length		3.55	
Custom cable (please specify length & diameter):					
<b>GLIDERS</b> Gliders are nickel-plated brass or cast steel. Use with uncoated 7 x 7 aircraft cable only.					
15-B3	A	Hanger for 3/64" - 1/16" cable		6.25	
18-B4	A	Hanger for 3/64" - 5/64" cable		6.55	
15Z-M6R2-SL2.6	B	Glider for 3/64" - 1/16" cable		6.85	
25Z-M6-SL3.0-S	B	Glider for 1/16" - 3/32" cable		8.55	
RT-15-HA	D	Hook for 3/64" - 1/16" cable		6.25	
18-HA	D	Hook for 3/64" - 5/64" cable		6.95	
ZF-15-GHA	E	Gated hook for 3/64" - 1/16" cable		6.25	
ZF-15-HA	n/a	Slim hook for 3/64" - 1/16" cable		5.55	
15-RI	H	Ring for 3/64" - 1/16" cable		6.25	
18-RI	H	Ring for 3/64" - 5/64" cable		6.95	
<b>TOTAL THIS PAGE</b>					

DRAWINGS NOT TO SCALE

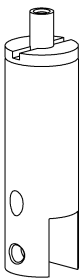

15Z-TC-250

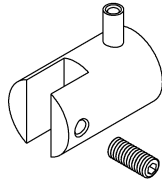

15-SC-250-L

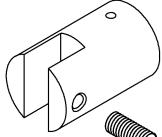

15-SC-250-R

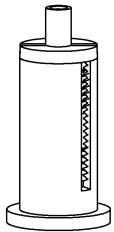

15Z-TC-400

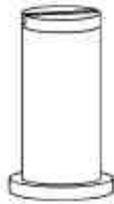

15Z-TC-250



RT-CC-M10



RT-12-M8

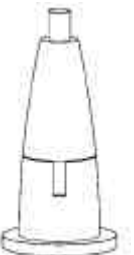

CC-1420-SL2.1



12-BS

12-BS

15-BS-1420

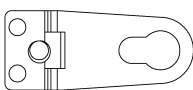

CC-M3X2-Q3.2

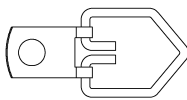

RH-STRAP-1



RH-STRAP-2

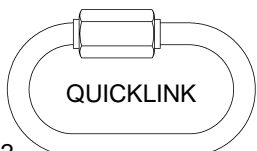

RH-BRACKET

QUICKLINK

CC-M3X2-Q3.2

Griplock P/N	Cat. Item	Description	Qty.	Price	Ext. Price
<b>CLAMPS</b>		Clamps are supplied with both nylon & steel set-screws & a hex-wrench. The 250 series holds material <math><0.25''</math>, the 400 series holds material <math><0.400''</math>.			
15-SC-250-L	L	Side clamp for <math><1/16''</math> cable (left)		6.85	
15-SC-250-R	L	Side clamp for <math><1/16''</math> cable (right)		6.85	
15-SC-400-L	L	Side clamp for <math><1/16''</math> cable (left)		6.85	
15-SC-400-R	L	Side clamp for <math><1/16''</math> cable (right)		6.85	
CC-SC-250	M	Guide clamp for <math><1/16''</math> cable		4.75	
CC-SC-400	M	Guide clamp for <math><1/16''</math> cable		4.75	
15Z-TC-250	N	Top clamp for <math><1/16''</math> cable		7.25	
15Z-TC-400	N	Top clamp for <math><1/16''</math> cable		7.55	
<b>CABLE COUPLERS</b>					
RT-CC-M8	S	2-pc. non-adjustable cable coupler		4.55	
RT-12-M8	T	2-pc. adjustable cable coupler for <math><3/64''</math> cable		6.35	
RT-CC-M10	O	2-pc. non-adjustable cable coupler		4.75	
RT-15-M10	P	2-pc. adjustable cable coupler for <math><1/16''</math> cable		6.55	
CC-1420-SL2.1	Q	2-pc. non-adjustable swivel coupler for sloped ceilings		6.25	
12-BS	R	3-pc. adjustable swivel coupler for <math><3/64''</math> cable		7.75	
15-BS-1420	R	3-pc. adjustable swivel coupler for <math><1/16''</math> cable		8.25	
CC-1420-ELP	U	2-pc. ellipse shaped non-adjustable cable coupler		6.25	
15Z-1420-ELP	V	2-pc. Ellipse shaped adjustable cable coupler for <math><1/16''</math> cable		7.85	
<b>ACCESSORIES</b>					
CC-M3X2-Q3.2	C	Cable collar		1.35	
RH-STRAP-1	p.4	1" strap hanger		0.55	
RH-STRAP-2	p.4	2" strap hanger		0.85	
RH-BRACKET	p.4	Metal frame bracket		0.55	
RH-QUICK-0.125	J	1" Quicklink		1.05	
<b>TOTAL THIS PAGE</b>					

## TOTALS and Shipping

TOTAL PAGE 1			
TOTAL PAGE 2			
HANDLING	Includes 86" shipping tube	15.00	
<b>TOTAL before Taxes &amp; Shipping (Taxes applicable to CA customers only)</b>			

**SHIPPING & HANDLING:** Customers pay shipping from Carpinteria, CA, 93013. Track pieces are shipped in a rigid cardboard tube (15 tracks per tube, approx.). An excess UPS shipping charge is applied. Tube is included in this charge. Continuous track cover ships in a separate container. All goods ship UPS ground unless specified.

**RETURN POLICY:** Goods must be returned within 30 days of purchase and must be deemed re-saleable by our quality control department. Goods are returned at customer's expense. All returned goods are subject to a 20% re-stocking fee. Restocking fee may be waived for exchanged goods. Goods cannot be returned without prior authorization from Griplock Systems. Please contact the Sales Team for details regarding all returns.

**PAYMENT TERMS:** Payments can be made by the following methods: credit card (American Express, MasterCard or Visa), COD, or prepay (checks from U.S. banks only. Please allow time for clearance). Credit terms are available, please ask our Sales Team for a Credit Application. Please note that Credit Accounts can take up to two weeks to set up. All payments include shipping charges. An invoice will be mailed to you after each transaction.

**WORKING LOAD:** Griplock Systems guarantees its Art Suspension products up to 35lbs. per 3/64" cable per 16" of track when the system has been professionally installed according to our published instructions. For heavier applications, use larger diameter cable.

SHIP TO: \_\_\_\_\_ ATTN: \_\_\_\_\_

STREET: \_\_\_\_\_ CITY: \_\_\_\_\_

STATE / PROVINCE: \_\_\_\_\_ ZIP: \_\_\_\_\_

PHONE: \_\_\_\_\_ FAX: \_\_\_\_\_ EMAIL: \_\_\_\_\_

CREDIT CARD #: \_\_\_\_\_ EXPIRATION: \_\_\_\_\_

CARDHOLDER SIGNATURE: \_\_\_\_\_ DATE: \_\_\_\_\_

PRINT NAME: \_\_\_\_\_

**BILLING ADDRESS (if different from above) :**

SHIP TO: \_\_\_\_\_ ATTN: \_\_\_\_\_

STREET: \_\_\_\_\_ CITY: \_\_\_\_\_

STATE / PROVINCE: \_\_\_\_\_ ZIP: \_\_\_\_\_

PHONE: \_\_\_\_\_

**PLEASE FILL OUT AND FAX BACK TO 805.566.0065**