

1/16" or 3/64" Cable

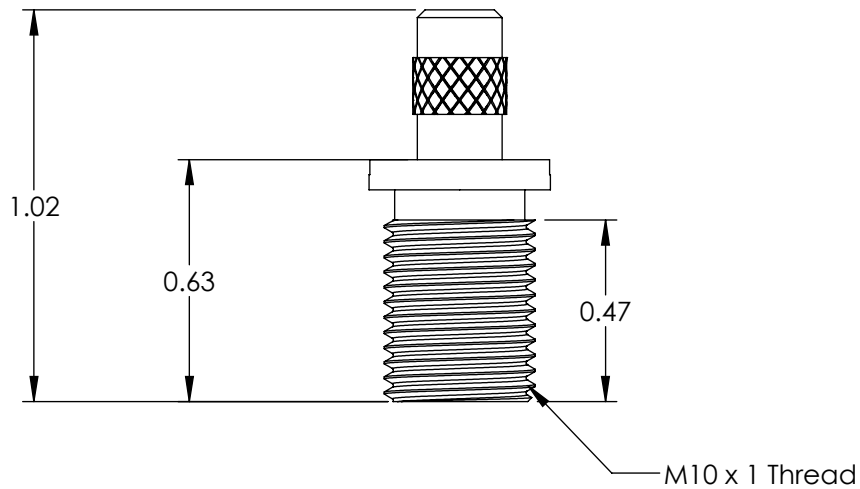
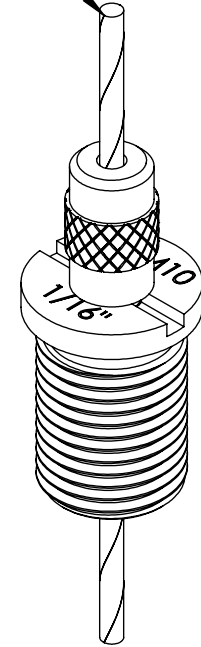
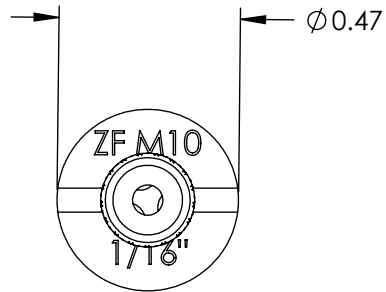

Unless otherwise specified  
 1. Dimensions are in inches  
 2. Tolerances are:  
 .XX ±.01 .XXX ±.005 Angles 1°  
 3. Break all edges .005 min  
 4. Finish 63 micro inches  
 5. Dimensions apply after finish  
 6. Concentricity = .025 TIR

DRAWN BY EPS REV INT  
 CHECKED BY

**PROPRIETARY AND CONFIDENTIAL**  
 This drawing and these specifications are the exclusive property of GRIPLOCK SYSTEMS LLC. and shall not be divulged, reproduced, copied, or used as the basis for the manufacture or sale of apparatus without the express written authorization of GRIPLOCK SYSTEMS LLC.

REF: \_\_\_\_\_ DATE: \_\_\_\_\_  
 MATERIAL: VARIOUS  
 SCALE: 2:1 FILE: ZF-15-M10-KFT-SC-CHR rA



**GRIPLOCK SYSTEMS**  
 1132 Mark Ave., Carpinteria, CA 93013  
 Phone (805) 566-0064 Fax (805) 566-0065  
 PART NUMBER: ZF-15-M10-KFT-SC-CHR  
 DESCRIPTION: Chrome Plated Gripper for 3/64" or 1/16" 7x7 or 7x19 Cable